

Mod. SW060A LC.07

codice Cliente

0

Cliente



Matric.	data:				
RIF	CODE		DESCRIZIONE	DESCRIPTION	PZ
1	BE0129		RACCORDO	NIPPLE	1
2	DE0094		FLANGIA	FLANGE	1
5	DE0728		FLANGIA	FLANGE	1
	GK0115		KIT TENUTE	SEAL KIT	1
23		GO0017	TENUTA	SEALS	4
			BO0018	O.RING	4
			BO0846	ANELLO	4
6		BO0069	O.RING	O.RING	3
39		BO0017	O.RING	O.RING	1
40		BO0020	O.RING	O.RING	1
46		BO0015	O.RING	O.RING	1
66		BO0006	O.RING	O.RING	1
	GK0429		KIT GIRANTE	TURBINE KIT	1
7		DI0770	INGRANAGGIO	GEAR	1
9		DN0716	PUNTALINO ASS.	THRUST PIN	1
34		DP0662	GIRANTE	TURBINE WHEEL	1
36		DP0734	BOCCOLA	BUSHING	1
38		AC0627	VITE	SCREW	4
8	DP0708		RONDELLA	WASHER	1
	GK0306		KIT ALBERO	SHAFT KIT	1
9		DN0716	PUNTALINO ASS.	THRUST PIN	1
15		DN0351	PRIGIONIERO	SCREW	1
26		DN1400	ALBERO	SHAFT	1
30		DN0825	PERNO	PIN	3
48	DE0074		FLANGIA	FLANGE	1
11	AC0441		VITE	SCREW	8
12	DI0474		PIGNONE	GEAR	1
13	DE0741		BOCCOLA	BUSHING	1
14	AA0672		VITE	SCREW	1
16	DA0022		CORPO	BODY	1
17	DI0477		CORONA	GEAR	1
18	AE0708		DADO	NUT	1

RIF	CODE		DESCRIZIONE	DESCRIPTION	PZ
19	DR0069		PORTAUGELLI	NOZZLE HOLDER	1
20	DP0714		RONDELLA	WASHER	1
21	DN0760		PERNO	PIN	1
22	DU0909		VITE	SCREW	1
24	DU0532		RONDELLA	WASHER	1
27	AC0454		VITE	SCREW	12
	GK0441		KIT SATELLITI	GEAR KIT	1
29		DP0190	INGRANAGGIO	GEAR	3
31	DI0468		CORONA	GEAR	1
	GK0304		KIT INGR.PORTASAT.	GEAR KIT	1
9		DN0716	PUNTALINO ASS.	THRUST PIN	2
30		DN0825	PERNO	PIN	3
32		GK0390	INGRANAGGIO	GEAR	1
			DE1164	FLANGIA	1
			DI0574	INGRANAGGIO	1
33	DE0924		DIFFUSORE	DIFFUSER	1
37	DN0835		PERNO	PIN	1
	GK0111		KIT CUSCINETTO	BEARING KIT	1
42		DE0753	RALLA	THRUST BEARING	1
45		DE0754	RALLA	THRUST BEARING	1
68	AN0535		TAPPO	PLUG	2
	GK0156		KIT GABBIA	CAGE KIT	1
43		BC0922	SFERA	BALL	12
44		DP0091	GABBIA	CAGE	1
55	DR0309		UGELLO	NOZZLES	2
56	DU0450		ANELLO	RING	1
57	DU0451		ANELLO	RING	1
	GK0120		KIT SATELLITI	GEAR KIT	1
10		GI0072	KIT SATELLITE	GEAR KIT	3
			DI0624	SATELLITE	3
			DE0588	BOCCOLA	3
65	DV0246		DADO	NUT	1

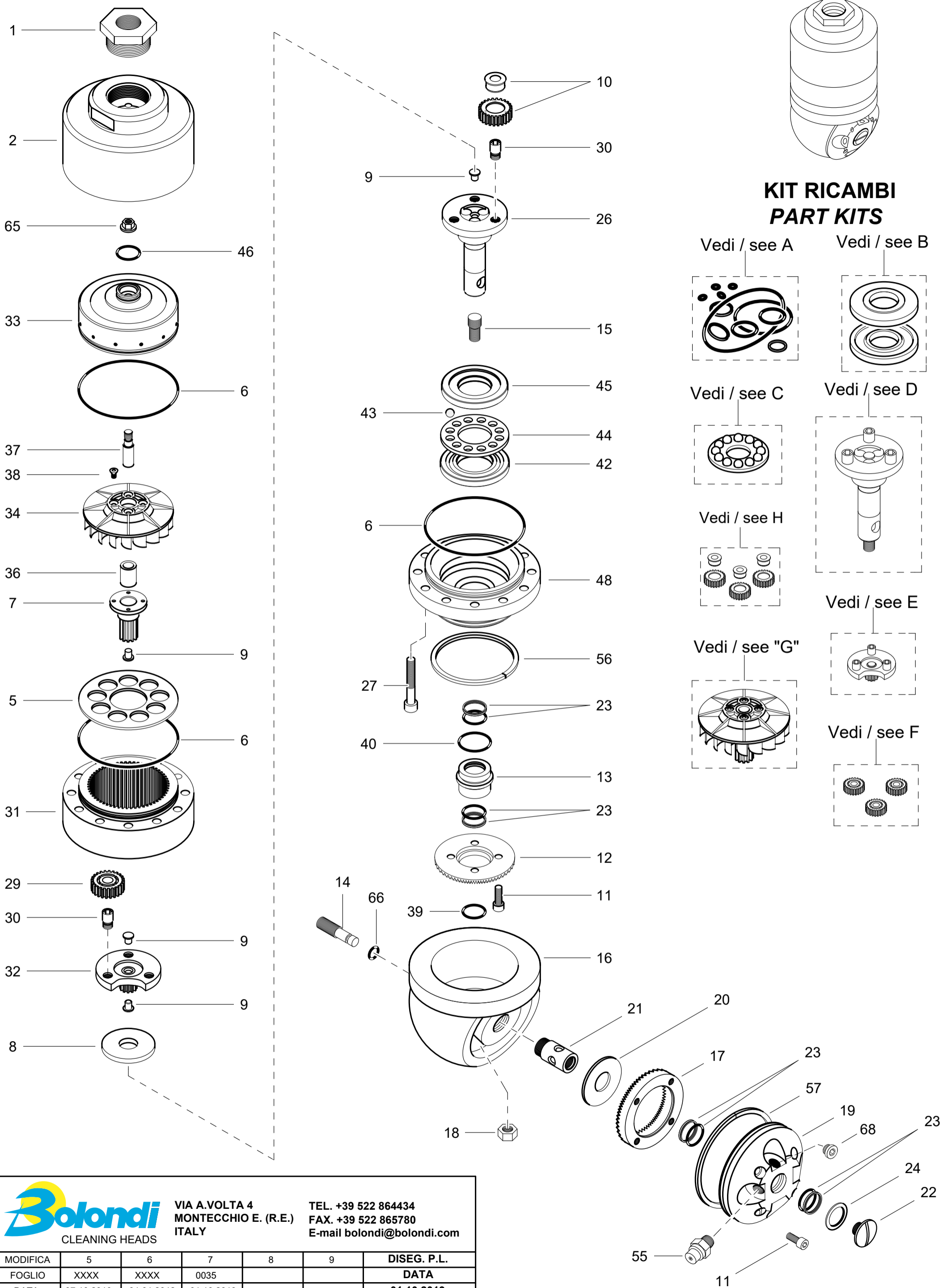

**Bolondi**  
CLEANING HEADS

VIA A.VOLTA 4  
MONTECCHIO E. (R.E.)  
ITALY

TEL. +39 522 864434  
FAX. +39 522 865780  
E-mail bolondi@bolondi.com

MODIFICA	5	6	7	8	9	DISEG. P.L.
FOGLIO	XXXX	XXXX	0035			DATA
DATA	07.10.2010	01.01.2012	01.10.2019			01.10.2019
MODELLO: SW060-LC						VERSIONE
NOTE:						07